

**TRUST  
THE  
ORIGINAL**

# BNC Connectors



**NEUTRIK<sup>®</sup>**

A brand of the Neutrik Group

| Content   | Page |
|---|------|
| UHD BNC - rearTWIST Cable Connectors .....          | 4    |
| HD BNC - rearTWIST Cable Connectors .....           | 5    |
| Cable to Connector Guide .....                      | 6    |
| Argosy Image .....                                  | 6    |
| Belden .....  | 6    |
| CAE .....   | 6    |
| Canare .....  | 7    |
| Canford .....                                       | 7    |
| Clark .....   | 7    |
| Commscope .....                                     | 7    |
| Cordial .....                                       | 7    |
| Draka Multimedia Cable .....                        | 8    |
| Direct Cable .....                                  | 8    |
| Kabeltronic .....                                   | 8    |
| KLOTZ .....   | 8    |
| Nexans .....  | 8    |
| Percon .....  | 9    |
| Proel .....   | 9    |
| RG .....  | 9    |
| Sommer .....  | 9    |
| Suhner .....  | 10   |
| Tesca .....   | 10   |
| Van Damme .....                                     | 10   |
| Others .....  | 10   |
| Connector to Cable Guide .....                      | 12   |
| rearTWIST HD & UHD .....                            | 12   |
| rearTWIST Tiny .....                                | 12   |
| Cable Jack Tiny & Panel Version .....               | 13   |
| UHD BNC - Chassis .....                             | 14   |
| HD BNC Chassis .....                                | 15   |
| HD BNC.Cable Jack Panel Version .....               | 16   |
| Technical Data .....                                | 17   |
| Accessories .....                                   | 18   |
| <b>General information:</b>                         |      |
| Definition, Abbreviation & Useful Information ..... | 19   |
| Neutrik Part Number Guide .....                     | 20   |
| Neutrik Product Line .....                          | 21   |

## BNC Connectors



### NEUTRIK® 75 Ω BNC Connectors



Neutrik offers a variety of 75 Ω cable and chassis BNC connectors. The rearTWIST cable connectors are easy to handle in high density applications such as video patchbays and switches, provide a tactile and fast assembly and offer colour coding as a standard. All parts of our BNC series are precisely machined to our high quality standards.

## rearTWIST® UHD – BNC Connector



With the transition to 4K or even 8K-signals the impedance of BNC connectors became more important than ever. Every deviate impedance has a negative influence on return loss and VSWR (Voltage Standing Wave Ratio) which are important measurements for reflected signals in a transmission line. Especially on high data rates up to 24 Gb/s, as they occur when transmitting ultra high definition (UHD) signals, an impedance mismatch results in high return loss.

Neutrik's new rearTWIST UHD-BNC connector is a specifically for high frequencies optimized BNC connector; based on the proven rearTWIST technology. The unique insulator design in combination with the reduced crimp diameter of the gold plated center pin allows UHD-data transmission within the required return loss limits.



### Features & Benefits

- ① Screen and cable jacket crimp instead of screen crimp only. Grooved inner surface holds the cable jacket to prevent tearing braids.
- ② High frequency optimized insulator design for UHD-transmissions.
- ③ Reduced pin crimp diameter for performance improvement (return loss values).
- ④ Swiss antraloy plating
- ⑤ rearTWIST boot for easy access in high density applications.



Gold plated contacts



Precise Swiss machined parts

**UHD** 4K8K

**rearTWIST UHD Connector**



NBNC75BFG7X

- Optimized contact pin and insulator design for UHD-data transmissions
- Proven rearTWIST technology
- Swiss antraly plating
- Fully compatible with conventional BNC chassis connectors
- Improved return loss values at high frequencies

**Neutrik BNCs – Excellent return loss!**

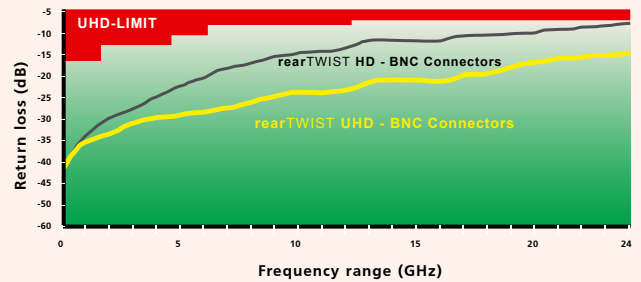

**NBNC75\***

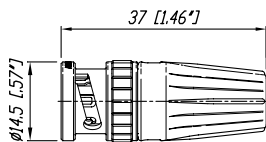



Bayonet locking



Gold plated contacts



9 different colors available

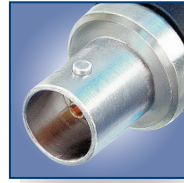

rearTWIST Female cable jack



## r e a r T W I S T H D



NBNC75BFG7



NBNC75BLP7



NBNB75GLP9



NBTB75CFI4

- "rearTWIST Principle" locking / unlocking using the easily accessible soft touch boot (Patent DE 100 48507)
- Ideal for recessed bulkheads where access to the "head" of the connector might be an issue. These connectors turn from the back and not the front.
- Snug-fit center pin insert provides tactile feedback
- Shield and jacket crimp technology prevents the problem of an exposed grounding braid on cable assemblies
- Large version for RG 11 cable
- Precise Swiss machined brass parts for outstanding durability
- Accessories include color coded boots in 10 standard colors, crimp tool and dies
- Sleek female cable jack e.g. for Y-cables

### NBNC75\*

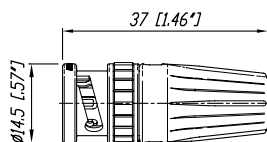

|  | rearTWIST<br>UHD | rearTWIST<br>HD | rearTWIST<br>HD Tiny | Cable Jack<br>& Panel | Pin Crimp<br>in mm | Hex Crimp<br>in mm | Stripping<br>Tool |            |            |              |
|--|------------------|-----------------|----------------------|-----------------------|--------------------|--------------------|-------------------|------------|------------|--------------|
|  |                  |                 |                      |                       | UHD                | HD                 | CS-BNC-RT         | CS-BNC-LCS | CS-BNC-LCV | + CS-BNC-TCI |

### ■ Argosy Image

|                   |              |             |  |             |      |     |      |   |   |   |   |
|-------------------|--------------|-------------|--|-------------|------|-----|------|---|---|---|---|
| Argosy Image 360  | NBNC75BFG7X  | NBNC75BFG7  |  |             | 1.07 | 1.6 | 5.00 | ● | - | - | - |
| Argosy Image 720  | NBNC75BLP9X  | NBNC75BLP9  |  |             | 1.07 | 1.6 | 6.47 | ● | - | - | - |
| Argosy Image 1000 | NBNC75BUU11X | NBNC75BUU11 |  | NBNB75GUU11 | 1.07 | 1.6 | 7.36 | ● | - | - | - |

### ■ Belden

|                                   |               |             |            |             |      |     |       |   |   |   |   |
|-----------------------------------|---------------|-------------|------------|-------------|------|-----|-------|---|---|---|---|
| Belden 1277R, 1278R, 1279R        |               |             | NBTC75BNN5 |             |      | 1.6 | 4.53  | ● | - | - | ● |
| Belden 1406B, 1407B, 1417B        |               |             | NBTC75BVV5 |             |      | 1.6 | 5.00  | ● | - | - | ● |
| Belden 1426A, 1505A (ANH), 4505R  | NBNC75BLP9X   | NBNC75BLP9  |            | NBNB75GLP9  | 1.07 | 1.6 | 6.47  | ● | - | - | - |
| Belden 1505F                      | NBNC75BJP9X   | NBNC75BJP9  |            |             | 1.07 | 1.6 | 6.47  | ● | - | - | - |
| Belden 1506A                      |               | NBNC75BIJ9  |            |             |      | 1.6 | 5.41  | ● | - | - | - |
| Belden 1520A, 1521A, 1522A, 179DT |               |             | NBTC75BFI4 | NBTB75CFI4  |      | 1.6 | 4.06  | ● | - | - | ● |
| Belden 1694A (ANH, DNH)           | NBNC75BTU11X  | NBNC75BTU11 |            |             | 1.07 | 1.6 | 7.36  | ● | - | - | - |
| Belden 1694F                      |               | NBNC75BRU11 |            |             |      | 1.6 | 7.36  | ● | - | - | - |
| Belden 1695A                      | NBNC75BQP11X  | NBNC75BQP11 |            |             | 1.07 | 1.6 | 6.47  | ● | - | - | - |
| Belden 1794A                      |               | NBNC75BZV14 |            |             |      | 1.6 | 8.23  | ● | - | - | - |
| Belden 1855A                      | NBNC75BDD6X   | NBNC75BDD6  |            |             | 1.07 | 1.6 | 4.53  | ● | - | - | - |
| Belden 1855EFN                    | NBNC75BFG7X   | NBNC75BFG7  |            |             | 1.07 | 1.6 | 5.00  | ● | - | - | - |
| Belden 1865A                      |               |             | NBTC75BXX6 |             |      | 1.6 | 5.00  | ● | - | - | ● |
| Belden 1855ENH                    | NBNC75BFG7X   | NBNC75BFG7  |            |             | 1.07 | 1.6 | 5.00  | ● | - | - | - |
| Belden 4505P                      |               | NBNC75BIJ9  |            |             |      | 1.6 | 5.41  | ● | - | - | - |
| Belden 4505R                      | NBNC75BLP9X   | NBNC75BLP9  |            |             | 1.07 | 1.6 | 6.47  | ● | - | - | - |
| Belden 4694P                      | NBNC75BQP11X  | NBNC75BQP11 |            |             | 1.07 | 1.6 | 6.47  | ● | - | - | - |
| Belden 4694R                      | NBNC75BTU11X  | NBNC75BTU11 |            |             | 1.07 | 1.6 | 7.36  | ● | - | - | - |
| Belden 4855P                      | NBNC75BDD6X   | NBNC75BDD6  |            |             | 1.07 | 1.6 | 4.53  | ● | - | - | - |
| Belden 4855R                      | NBNC75BDD6X   | NBNC75BDD6  |            |             | 1.07 | 1.6 | 4.53  | ● | - | - | ● |
| Belden 7731A (ANH)                |               | NBNC75BVZ17 |            |             |      | 1.8 | 10.00 | - | - | ● | - |
| Belden 8218                       |               |             | NBTC75BXX5 |             |      | 1.6 | 5.00  | ● | - | - | ● |
| Belden 8241                       | NBNC75BLP7X   | NBNC75BLP7  |            |             | 1.07 | 1.6 | 6.47  | ● | - | - | - |
| Belden 8241F                      | NBNC75BLP9X   | NBNC75BLP9  |            | NBNB75GLP9  | 1.07 | 1.6 | 6.47  | ● | - | - | - |
| Belden 8281                       |               | NBNC75BXY9  |            |             |      | 1.6 | 8.23  | ● | - | - | - |
| Belden 8281F                      |               | NBNC75BY9   |            |             |      | 1.6 | 8.23  | ● | - | - | - |
| Belden 9221                       |               |             | NBTC75BLI4 |             |      | 1.6 | 4.06  | ● | - | - | ● |
| Belden 70078CH HDTV               |               |             | NBTC75BNN5 | NBTB75CINN5 |      | 1.6 | 4.53  | ● | - | - | ● |
| Belden 70080, 70080NH             | NBNC75BFG7X   | NBNC75BFG7  |            |             | 1.07 | 1.6 | 5.00  | ● | - | - | - |
| Belden 70081, 70081NH             | NBNC75BLP9X   | NBNC75BLP9  |            |             | 1.07 | 1.6 | 6.47  | ● | - | - | - |
| Belden 70082, 70082CH & 70082NH   | NBNC75BTU11X  | NBNC75BTU11 |            |             | 1.07 | 1.6 | 7.36  | ● | - | - | - |
|                                   | NBNC75BTUP11X |             |            |             | 1.07 |     | 7.06  | ● | - | - | - |

### ■ CAE

|                 |             |             |            |            |      |     |       |   |   |   |   |
|-----------------|-------------|-------------|------------|------------|------|-----|-------|---|---|---|---|
| CAE MC75        |             |             | NBTC75BLI5 | NBTB75CLI5 |      | 1.6 | 4.06  | ● | - | - | ● |
| CAE MC75.39     |             |             | NBTC75BVX6 |            |      | 1.6 | 5.00  | ● | - | - | ● |
| CAE KX6A        | NBNC75BLP7X | NBNC75BLP7  |            |            | 1.07 | 1.6 | 6.47  | ● | - | - | - |
| CAE VCB75       |             | NBNC75BNP9  |            |            |      | 1.6 | 6.47  | ● | - | - | - |
| CAE VCB 100     |             | NBNC75BXU13 |            |            |      | 1.6 | 7.36  | ● | - | - | - |
| CAE HD1250FLEX  |             | NBNC75BXU13 |            |            |      | 1.6 | 7.01  | ● | - | - | - |
| CAE HD10460LSZH |             | NBNC75BTS11 |            |            |      | 1.6 | 7.01  | ● | - | - | - |
| CAE HD0628LSZH  | NBNC75BFG7X | NBNC75BFG7  |            |            | 1.07 | 1.6 | 5.00  | ● | - | - | - |
| CAE HD08370LSZH | NBNC75BLP9X | NBNC75BLP9  |            |            | 1.07 | 1.6 | 6.47  | ● | - | - | - |
| CAE HD16720LSZH |             | NBNC75BVZ17 |            |            |      | 1.8 | 10.00 | - | - | ● | - |



|  | rearTWIST | rearTWIST | rearTWIST | Cable Jack<br>& Panel | Pin Crimp |       | Hex Crimp | Stripping |            |            |              |
|--|-----------|-----------|-----------|-----------------------|-----------|-------|-----------|-----------|------------|------------|--------------|
|  | UHD       | HD        | HD Tiny   |                       | in mm     | in mm | in mm     | Tool      |            |            |              |
|  |           |           |           |                       | UHD       | HD    |           | CS-BNC-RT | CS-BNC-LCS | CS-BNC-LCV | + CS-BNC-TCI |

### ■ Canare

|                            |              |             |            |            |      |     |      |      |   |   |   |
|----------------------------|--------------|-------------|------------|------------|------|-----|------|------|---|---|---|
| Canare L-2.5CHWS           | NBNC75BFG7X  | NBNC75BFG7  |            |            | 1.07 | 1.6 | 5.00 | ●    | - | - | - |
| Canare L-3CFB, L-3C2VS     |              | NBNC75BHK7  |            |            |      |     | 1.6  | 5.41 | ● | - | - |
| Canare L-3.3CUHD           | NBNC75BLP9X  | NBNC75BLP9  |            |            | 1.07 | 1.6 | 6.47 | ●    | - | - | - |
| Canare L-4CFB              | NBNC75BLP9X  | NBNC75BLP9  |            | NBNB75GLP9 | 1.07 | 1.6 | 6.47 | ●    | - | - | - |
| Canare L-4.5CHD, L-4.5CHWS | NBNC75BTU11X | NBNC75BTU11 |            |            | 1.07 | 1.6 | 7.36 | ●    | - | - | - |
| Canare L-5CFB              |              | NBNC75BYY11 |            |            |      | 1.6 | 8.23 | ●    | - | - | - |
| Canare L-5.5 CUHD          | NBNC75BZV14X |             |            |            |      | 1.6 | 8.23 | -    | ● | - | - |
| Canare LV-61S              | NBNC75BLP7X  | NBNC75BLP7  |            |            | 1.07 | 1.6 | 6.47 | ●    | - | - | - |
| Canare LV-77S              |              | NBNC75BYY9  |            |            |      | 1.6 | 8.23 | ●    | - | - | - |
| Canare V(3-5)-3C           |              | NBNC75BGG7  |            |            |      | 1.6 | 5.00 | ●    | - | - | - |
| Canare V(3-5)-4CFB         |              | NBNC75BJJ9  |            |            |      | 1.6 | 5.41 | ●    | - | - | - |
| Canare V(3-5)-5C           |              | NBNC75BRS9  |            |            |      | 1.6 | 7.01 | ●    | - | - | - |
| Canare V(3-5)-5CFB         |              | NBNC75BWS11 |            |            |      | 1.6 | 7.01 | ●    | - | - | - |
| Canare L-1.5C2VS           |              |             | NBTC75BLI4 |            |      | 1.6 | 4.06 | ●    | - | - | ● |
| Canare L-3CFW              | NBNC75BLP7X  | NBNC75BLP7  |            |            | 1.07 | 1.6 | 6.47 | ●    | - | - | - |
| Canare L-5CFW              |              | NBNC75BYY11 |            |            |      | 1.6 | 8.23 | ●    | - | - | - |

### ■ Canford

|                          |              |             |  |  |      |     |       |   |   |   |   |
|--------------------------|--------------|-------------|--|--|------|-----|-------|---|---|---|---|
| Canford SDV, SDV-X, SDM  | NBNC75BFG7X  | NBNC75BFG7  |  |  | 1.07 | 1.6 | 5.00  | ● | - | - | - |
| Canford SDV-F, SDV-XF    |              | NBNC75BUU11 |  |  |      | 1.6 | 7.36  | ● | - | - | - |
| Canford SDV-F-HD         |              | NBNC75BWU13 |  |  |      | 1.6 | 7.36  | ● | - | - | - |
| Canford SDV-HD           |              | NBLC75BVZ17 |  |  |      | 1.8 | 10.00 | - | - | ● | - |
| Canford SDV-I-X-LFH      | NBNC75BLP9X  | NBNC75BLP9  |  |  | 1.07 | 1.6 | 6.47  | ● | - | - | - |
| Canford SDV-L, SDV-F     | NBNC75BUU11X | NBNC75BUU11 |  |  |      | 1.6 | 7.01  | ● | - | - | - |
| Canford SDV-M            |              | NBTB75CNN5  |  |  |      | 1.6 | 4.53  | ● | - | - | ● |
| Canford VCS (BBC PSF1/3) |              | NBNC75BLS7  |  |  |      | 1.6 | 7.01  | ● | - | - | - |

### ■ Clark

|                           |              |             |  |  |      |     |      |   |   |   |   |
|---------------------------|--------------|-------------|--|--|------|-----|------|---|---|---|---|
| Clark CD7559-0, CD7559F-0 | NBNC75BLP9X  | NBNC75BLP9  |  |  | 1.07 | 1.6 | 6.47 | ● | - | - | - |
| Clark CD7523-7            | NBNC75BDD6X  | NBNC75BDD6  |  |  | 1.07 | 1.6 | 4.53 | ● | - | - | ● |
| Clark CD7506-0            | NBNC75BTU11X | NBNC75BTU11 |  |  | 1.07 | 1.6 | 7.36 | ● | - | - | - |
| Clark CD7506F-0           |              | NBNC75BRU11 |  |  |      | 1.6 | 7.36 | ● | - | - | - |

### ■ Commscope

|                        |              |             |            |            |      |     |      |   |   |   |   |
|------------------------|--------------|-------------|------------|------------|------|-----|------|---|---|---|---|
| Commscope 2065V        |              | NBNC75BIJ9  |            |            |      | 1.6 | 5.41 | ● | - | - | - |
| Commscope 2279V        |              | NBNC75BQP11 |            |            |      | 1.6 | 6.47 | ● | - | - | - |
| Commscope 5563         | NBNC75BLP7X  | NBNC75BLP7  |            |            | 1.07 | 1.6 | 6.47 | ● | - | - | - |
| Commscope 5565         | NBNC75BLP9X  | NBNC75BLP9  |            | NBNB75GLP9 | 1.07 | 1.6 | 6.47 | ● | - | - | - |
| Commscope 5765         | NBNC75BTU11X | NBNC75BTU11 |            |            | 1.07 | 1.6 | 7.36 | ● | - | - | - |
| Commscope 7536 (03-05) |              |             | NBTC75BXX6 |            |      | 1.6 | 5.00 | ● | - | - | ● |
| Commscope 7538         | NBNC75BDD6X  | NBNC75BDD6  |            |            | 1.07 | 1.6 | 4.53 | ● | - | - | - |

### ■ Cordial

|                                       |              |             |  |  |      |     |      |   |   |   |   |
|---------------------------------------|--------------|-------------|--|--|------|-----|------|---|---|---|---|
| Cordial CVI 3-7                       | NBNC75BFG7X  | NBNC75BFG7  |  |  | 1.07 | 1.6 | 4.53 | ● | - | - | - |
| Cordial CVI 06-28                     | NBNC75BFG7X  | NBNC75BFG7  |  |  | 1.07 | 1.6 | 5.00 | ● | - | - | - |
| Cordial CVI 06-28HD, CVI 06-28HD-FRNC | NBNC75BFG7X  | NBNC75BFG7  |  |  | 1.07 | 1.6 | 5.00 | ● | - | - | - |
| Cordial CVI (CVM) 06-37               | NBNC75BLP7X  | NBNC75BLP7  |  |  | 1.07 | 1.6 | 6.47 | ● | - | - | - |
| Cordial CVI 08-37 HD-FRNC             |              | NBNC75BNP9  |  |  |      | 1.6 | 6.47 | ● | - | - | - |
| Cordial CVI 10-48 HD                  | NBNC75BUU11X | NBNC75BUU11 |  |  | 1.07 | 1.6 | 7.36 | ● | - | - | - |

|                            | rearTWIST UHD | rearTWIST HD | rearTWIST HD Tiny | Cable Jack & Panel | Pin Crimp in mm |    | Hex Crimp in mm | Stripping Tool |            |            |              |   |
|----------------------------|---------------|--------------|-------------------|--------------------|-----------------|----|-----------------|----------------|------------|------------|--------------|---|
|                            |               |              |                   |                    | UHD             | HD |                 | CS-BNC-RT      | CS-BNC-LCS | CS-BNC-LCV | + CS-BNC-TCI |   |
| Cordial CVI 10-48 HD-FRNC  |               | NBNC75BWS11  |                   |                    |                 |    | 1.6             | 7.01           | ●          | -          | -            | - |
| Cordial CVM 08-32 HD-FLEX  |               | NBNC75BIJ9   |                   |                    |                 |    | 1.6             | 5.41           | ●          | -          | -            | - |
| Cordial CVM 08-37 UHD-FLEX | NBNC75BJP9X   | NBNC75BJP9   |                   |                    | 1.07            |    | 1.6             | 6.47           | ●          | -          | -            | - |
| Cordial CVM 12-50 HD-FLEX  |               | NBNC75BWU13  |                   |                    |                 |    | 1.6             | 7.36           | ●          | -          | -            | - |
| Cordial CVM 12-50 UHD-FLEX |               | NBNC75BWU13  |                   |                    |                 |    | 1.6             | 7.36           | ●          | -          | -            | - |

### ■ Draka Multimedia Cable

|   |              |             |            |             |      |  |      |       |   |   |   |   |
|---|--------------|-------------|------------|-------------|------|--|------|-------|---|---|---|---|
| 0.31 / 1.45 AF, 753-1304(2), 755-1302       |              |             | NBTC75BFI4 | NBTB75CFI4  |      |  | 1.6  | 4.06  | ● | - | - | ● |
| 0.41 / 1.9 AF, 753-1104, 755-1103, 755-1101 |              |             | NBTC75BNN5 | NBTB75CNN5  |      |  | 1.6  | 4.53  | ● | - | - | ● |
| 0.51 / 2.3 Dz, 757-1001, VADN 7243          |              |             | NBTC75BVX6 |             |      |  | 1.6  | 5.00  | ● | - | - | ● |
| 0.6 / 2.8 AF, 0.6 L / 2.8 AF                | NBNC75BFG7X  | NBNC75BFG7  |            |             | 1.07 |  | 1.6  | 5.00  | ● | - | - | - |
| HD Pro 0.6/2.8 AF                           | NBNC75BFG7X  | NBNC75BFG7  |            |             | 1.07 |  | 1.6  | 5.00  | ● | - | - | - |
| 0.6 / 3.7, 0.6L / 3.7                       | NBNC75BLP7X  | NBNC75BLP7  |            |             | 1.07 |  | 1.6  | 6.47  | ● | - | - | - |
| 0.6 / 3.7 Dz                                |              | NBNC75BLS7  |            |             |      |  | 1.6  | 7.01  | ● | - | - | - |
| 0.8 / 3.7 AF, 755-801(803, 804)             | NBNC75BLP9X  | NBNC75BLP9  |            | NBNB75GLP9  | 1.07 |  | 1.6  | 6.47  | ● | - | - | - |
| Highflex 08L/3.7D, HD Pro 0.8/3.7 AF        | NBNC75BLP9X  | NBNC75BLP9  |            |             | 1.07 |  | 1.6  | 6.47  | ● | - | - | - |
| 0.8 / 4.9 Dz                                |              | NBNC75BXY9  |            |             |      |  | 1.6  | 8.23  | ● | - | - | - |
| 1.0 / 4.8 AF, 755-901/5                     | NBNC75BUU11X | NBNC75BUU11 |            | NBNB75GUU11 | 1.07 |  | 1.6  | 7.36  | ● | - | - | - |
| 1.2L / 4.8Dz, 1.2L / 4.95AF                 |              | NBNC75BWU13 |            |             |      |  | 1.6  | 7.36  | ● | - | - | - |
| 1.4 / 6.6 AF                                |              | NBLC75BSX14 |            |             |      |  | 1.75 | 9.73  | - | ● | - | - |
| 1.6 / 7.3AF                                 |              | NBLC75BVZ17 |            |             |      |  | 1.8  | 10.00 | - | - | ● | - |
| Ultra HD PRO50 UHD                          | NBNC75BFG7X  | NBNC75BFG7  |            |             | 1.07 |  | 1.6  | 5.00  | ● | - | - | - |

### ■ Direct Cable

|                      |              |             |  |  |      |  |     |      |   |   |   |   |
|----------------------|--------------|-------------|--|--|------|--|-----|------|---|---|---|---|
| Direct Cable 301-299 | NBNC75BLP9X  | NBNC75BLP9  |  |  | 1.07 |  | 1.6 | 6.47 | ● | - | - | - |
| Direct Cable 301-330 | NBNC75BTU11X | NBNC75BTU11 |  |  | 1.07 |  | 1.6 | 7.36 | ● | - | - | - |
| Direct Cable 301-340 |              | NBNC75BRU11 |  |  |      |  | 1.6 | 7.60 | ● | - | - | - |
| Direct Cable 301-351 | NBNC75BFG7X  | NBNC75BFG7  |  |  | 1.07 |  | 1.6 | 5.00 | ● | - | - | - |
| Direct Cable 301-361 | NBNC75BTU11X | NBNC75BTU11 |  |  | 1.07 |  | 1.6 | 7.36 | ● | - | - | - |
| Direct Cable 360-036 | NBNC75BFG7X  | NBNC75BFG7  |  |  | 1.07 |  | 1.6 | 5.00 | ● | - | - | - |
| Direct Cable 360-031 | NBNC75BFG7X  | NBNC75BFG7  |  |  | 1.07 |  | 1.6 | 5.00 | ● | - | - | - |

### ■ Kabeltronik

|                                    |             |             |  |  |      |  |     |      |   |   |   |   |
|------------------------------------|-------------|-------------|--|--|------|--|-----|------|---|---|---|---|
| Kabeltronik HFV 1.0/4.8 AF-FRNC    |             | NBNC75BRU11 |  |  |      |  | 1.6 | 7.36 | ● | - | - | - |
| Kabeltronik HFV 0.6/2.8 AF-FRNC    | NBNC75BFG7X | NBNC75BFG7  |  |  | 1.07 |  | 1.6 | 5.00 | ● | - | - | - |
| Kabeltronik MVP 5x 0.6/2.8 AF-FRNC | NBNC75BFG7X | NBNC75BFG7  |  |  | 1.07 |  | 1.6 | 5.00 | ● | - | - | - |

### ■ KLOTZ

|                               |              |             |  |             |      |  |     |       |   |   |   |   |
|-------------------------------|--------------|-------------|--|-------------|------|--|-----|-------|---|---|---|---|
| KLOTZ V06/28, V062SH, VMXx75Y | NBNC75BFG7X  | NBNC75BFG7  |  |             | 1.07 |  | 1.6 | 5.00  | ● | - | - | - |
| KLOTZ V06/37                  | NBNC75BLP7X  | NBNC75BLP7  |  |             | 1.07 |  | 1.6 | 6.47  | ● | - | - | - |
| KLOTZ V08/37H, VD083SH        | NBNC75BLP9X  | NBNC75BLP9  |  |             | 1.07 |  | 1.6 | 6.47  | ● | - | - | - |
| KLOTZ V10/48, V10/48H         | NBNC75BUU11X | NBNC75BUU11 |  | NBNB75GUU11 | 1.07 |  | 1.6 | 7.36  | ● | - | - | - |
| KLOTZ V16/72                  |              | NBLC75BVZ17 |  |             |      |  | 1.8 | 10.00 | - | - | ● | - |
| KLOTZ VD083LP 0.8L/3.7DZ      | NBNC75BJP9X  | NBNC75BJP9  |  |             | 1.07 |  | 1.6 | 6.47  | ● | - | - | - |
| KLOTZ VD125LPS                |              | NBNC75BWU13 |  |             |      |  | 1.6 | 7.36  | ● | - | - | - |
| KLOTZ VD167SH-E               |              | NBLC75BVZ17 |  |             |      |  | 1.8 | 10.00 | - | - | ● | - |



|  | rearTWIST<br>UHD | rearTWIST<br>HD | rearTWIST<br>HD Tiny | Cable Jack<br>& Panel | Pin Crimp<br>in mm | Hex Crimp<br>in mm | Stripping<br>Tool |           |            |            |              |
|--|------------------|-----------------|----------------------|-----------------------|--------------------|--------------------|-------------------|-----------|------------|------------|--------------|
|  |                  |                 |                      |                       | UHD                | HD                 |                   | CS-BNC-RT | CS-BNC-LCS | CS-BNC-LCV | + CS-BNC-TCI |

### ■ Nexans

|                                    |             |             |  |  |      |     |      |       |   |   |   |
|------------------------------------|-------------|-------------|--|--|------|-----|------|-------|---|---|---|
| Nexans HF 75 0.6/2.9 02YS(ST)CH    | NBNC75BFG7X | NBNC75BFG7  |  |  | 1.07 | 1.6 | 5.00 | ●     | - | - | - |
| Nexans HF 75 1.6/7.2 02Y(ST)C(ST)H |             | NBNC75BVZ17 |  |  |      |     | 1.8  | 10.00 | - | - | ● |
| Nexans HF 75 0.6/3.7 2YCY          | NBNC75BLP7X | NBNC75BLP7  |  |  | 1.07 | 1.6 | 6.47 | ●     | - | - | - |

### ■ Percon

|                 |              |             |            |  |      |      |      |   |   |   |   |
|-----------------|--------------|-------------|------------|--|------|------|------|---|---|---|---|
| Percon VK2      |              |             | NBTC75BNN5 |  |      | 1.6  | 4.53 | ● | - | - | ● |
| Percon VK5      | NBNC75BFG7X  | NBNC75BFG7  |            |  | 1.07 | 1.6  | 5.00 | ● | - | - | - |
| Percon VK6      | NBNC75BLP9X  | NBNC75BLP9  |            |  | 1.07 | 1.6  | 6.47 | ● | - | - | - |
| Percon VK66 ENH | NBNC75BJP9X  | NBNC75BJP9  |            |  | 1.07 | 1.6  | 6.47 | ● | - | - | - |
| Percon VK7      | NBNC75BUU11X | NBNC75BUU11 |            |  | 1.07 | 1.6  | 7.36 | ● | - | - | - |
| Percon VK77     | NBNC75BTU11X | NBNC75BTU11 |            |  | 1.07 | 1.6  | 7.36 | ● | - | - | - |
| Percon VK770F   |              | NBNC75BWU13 |            |  |      | 1.6  | 7.36 | ● | - | - | - |
| Percon VK8      |              | NBLC75BSX14 |            |  |      | 1.75 | 9.73 | - | ● | - | - |
| Percon VK9      |              | NBLC75BVZ17 |            |  |      | 1.8  | 10.0 | - | - | ● | - |
| Percon VK95     | NBNC75BLP7X  | NBNC75BLP7  |            |  | 1.07 | 1.6  | 6.47 | ● | - | - | - |

### ■ Proel

|               |             |            |  |  |      |     |      |   |   |   |   |
|---------------|-------------|------------|--|--|------|-----|------|---|---|---|---|
| Proel HPC 805 | NBNC75BLP7X | NBNC75BLP7 |  |  | 1.07 | 1.6 | 6.47 | ● | - | - | - |
| Proel HPC 810 | NBNC75BLP9X | NBNC75BLP9 |  |  | 1.07 | 1.6 | 6.47 | ● | - | - | - |
| Proel HPC 820 |             | NBNC75BFH6 |  |  |      | 1.6 | 5.00 | ● | - | - | - |

### ■ RG

|          |             |             |            |  |      |     |       |   |   |   |   |
|----------|-------------|-------------|------------|--|------|-----|-------|---|---|---|---|
| RG11     |             | NBLC75BVZ17 |            |  |      | 1.8 | 10.00 | - | - | ● | - |
| RG59B/U  | NBNC75BLP7X | NBNC75BLP7  |            |  | 1.07 | 1.6 | 6.47  | ● | - | - | - |
| RG179B/U |             |             | NBTC75BLI4 |  |      | 1.6 | 4.06  | ● | - | - | ● |

### ■ SOMMER

|                                  |              |             |            |            |      |      |       |   |   |   |   |
|----------------------------------|--------------|-------------|------------|------------|------|------|-------|---|---|---|---|
| SOMMER 600-0041C                 |              |             | NBTC75NBS4 |            |      | 1.6  | 4.53  | ● | - | - | - |
| SOMMER 600-0051 (M/L/S)          | NBNC75BLP7X  | NBNC75BLP7  |            |            | 1.07 | 1.6  | 6.47  | ● | - | - | - |
| SOMMER 600-0054 (M/L/S)          | NBNC75BLP7X  | NBNC75BLP7  |            |            | 1.07 | 1.6  | 6.47  | ● | - | - | - |
| SOMMER 600-0101M                 | NBNC75BFG7X  | NBNC75BFG7  |            |            | 1.07 | 1.6  | 5.00  | ● | - | - | - |
| SOMMER 600-0104M                 | NBNC75BFG7X  | NBNC75BFG7  |            |            | 1.07 | 1.6  | 5.00  | ● | - | - | - |
| SOMMER 600-0131                  |              | NBLC75BSX14 |            |            |      | 1.75 | 9.73  | - | ● | - | - |
| SOMMER 600-0144                  | NBNC75BUU11X | NBNC75BUU11 |            |            | 1.07 | 1.6  | 7.36  | ● | - | - | - |
| SOMMER 600-162(F), Vctor 0.8/3.7 | NBNC75BLP9X  | NBNC75BLP9  |            |            | 1.07 | 1.6  | 6.47  | ● | - | - | - |
| SOMMER 600-0174                  |              | NBNC75BWU13 |            |            |      | 1.6  | 7.36  | ● | - | - | - |
| SOMMER 600-0174FC                |              | NBNC75BWU13 |            |            |      | 1.6  | 7.36  | ● | - | - | - |
| SOMMER 600-0214                  |              | NBNC75BWU13 |            |            |      | 1.6  | 7.36  | ● | - | - | - |
| SOMMER 600-025* -03 (05)         |              |             | NBTC75BLI5 | NBTB75CLI5 |      | 1.6  | 4.06  | ● | - | - | ● |
| SOMMER 600-0701                  |              |             | NBTC75BLI5 | NBTB75CLI5 |      | 1.6  | 4.06  | ● | - | - | ● |
| SOMMER 600-020* -03 (05)         |              |             | NBTC75BLI5 | NBTB75CLI5 |      | 1.6  | 4.06  | ● | - | - | ● |
| SOMMER 600-0234                  |              | NBLC75BVZ17 |            |            |      | 1.8  | 10.00 | - | - | ● | - |
| SOMMER 600-0234FC                |              | NBLC75BVZ17 |            |            |      | 1.8  | 10.00 | - | - | ● | - |
| SOMMER 600-0451                  | NBNC75BLP9X  | NBNC75BLP9  |            | NBNB75GLP9 | 1.07 | 1.6  | 6.47  | ● | - | - | - |
| SOMMER 600-0621-05               | NBNC75BFG7X  | NBNC75BFG7  |            |            | 1.07 | 1.6  | 5.00  | ● | - | - | - |
| SOMMER 600-0751                  |              |             | NBTC75BVX6 |            |      | 1.6  | 5.00  | ● | - | - | ● |
| SOMMER 600-0791                  | NBNC75BFG7X  | NBNC75BFG7  |            |            | 1.07 | 1.6  | 5.00  | ● | - | - | - |
| SOMMER 600-0851                  | NBNC75BFG7X  | NBNC75BFG7  |            |            | 1.07 | 1.6  | 5.00  | ● | - | - | - |
| SOMMER 600-0851-05               | NBNC75BFG7X  | NBNC75BFG7  |            |            | 1.07 | 1.6  | 5.00  | ● | - | - | - |

|                       | rearTWIST    | rearTWIST   | rearTWIST  | Cable Jack<br>& Panel | Pin Crimp |       | Hex Crimp | Stripping |            |            |              |  |  |  |
|-----------------------|--------------|-------------|------------|-----------------------|-----------|-------|-----------|-----------|------------|------------|--------------|--|--|--|
|                       | UHD          | HD          | HD Tiny    |                       | in mm     | in mm | in mm     | Tool      |            |            |              |  |  |  |
|                       |              |             |            |                       | UHD       | HD    |           | CS-BNC-RT | CS-BNC-LCS | CS-BNC-LCV | + CS-BNC-TCI |  |  |  |
| SOMMER 600-1031       |              | NBNC75BWU13 |            |                       |           | 1.6   | 7.36      | ●         | -          | -          | -            |  |  |  |
| SOMMER 600-1451       | NBNC75BFG7X  | NBNC75BFG7  |            |                       | 1.07      | 1.6   | 5.00      | ●         | -          | -          | -            |  |  |  |
| -SOMMER 600-2001      |              | NBNC75BWU13 |            |                       |           | 1.6   | 7.36      | ●         | -          | -          | -            |  |  |  |
| SOMMER 600-2031       |              | NBNC75BWU13 |            |                       |           | 1.6   | 7.36      | ●         | -          | -          | -            |  |  |  |
| SOMMER 600-2101       | NBNC75BFG7X  | NBNC75BFG7  |            |                       | 1.07      | 1.6   | 5.00      | ●         | -          | -          | -            |  |  |  |
| SOMMER 600-2231       | NBNC75BLP9X  | NBNC75BLP9  |            |                       | 1.07      | 1.6   | 6.47      | ●         | -          | -          | -            |  |  |  |
| SOMMER 600-2781       |              | NBNC75BWU13 |            |                       |           | 1.6   | 7.36      | ●         | -          | -          | -            |  |  |  |
| SOMMER 600-2791       |              | NBNC75BWU13 |            |                       |           | 1.6   | 7.36      | ●         | -          | -          | -            |  |  |  |
| SOMMER 600-2811-01    |              | NBNC75BWU13 |            |                       |           | 1.6   | 7.36      | ●         | -          | -          | -            |  |  |  |
| SOMMER 600-3202       |              | NBNC75BWU13 |            |                       |           | 1.6   | 7.36      | ●         | -          | -          | -            |  |  |  |
| SOMMER 605-0761       | NBNC75BFG7X  | NBNC75BFG7  |            |                       | 1.07      | 1.6   | 5.00      | ●         | -          | -          | -            |  |  |  |
| <b>■ Suhner</b>       |              |             |            |                       |           |       |           |           |            |            |              |  |  |  |
| Suhner G02233         |              |             | NBTC75BF14 | NBTB75CF14            |           | 1.6   | 4.06      | ●         | -          | -          | ●            |  |  |  |
| Suhner G04233D        |              | NBNC75BLS7  |            |                       |           | 1.6   | 7.01      | ●         | -          | -          | -            |  |  |  |
| Suhner S02223         |              |             | NBTC75BL14 |                       |           | 1.6   | 4.06      | ●         | -          | -          | ●            |  |  |  |
| Suhner S04233, S04263 | NBNC75BLP9X  | NBNC75BLP9  |            | NBNB75GLP9            | 1.07      | 1.6   | 6.47      | ●         | -          | -          | -            |  |  |  |
| Suhner S05133-07      | NBNC75BTU11X | NBNC75BTU11 |            |                       | 1.07      | 1.6   | 7.36      | ●         | -          | -          | -            |  |  |  |
| Suhner S05163-02      | NBNC75BTU11X | NBNC75BTU11 |            |                       | 1.07      | 1.6   | 7.36      | ●         | -          | -          | -            |  |  |  |
| <b>■ Tasker</b>       |              |             |            |                       |           |       |           |           |            |            |              |  |  |  |
| Tasker RGB75          |              |             | NBTC75BF14 |                       |           | 1.6   | 4.06      | ●         | -          | -          | -            |  |  |  |
| Tasker RG59BU         |              | NBNC75BLP7  |            |                       |           | 1.6   | 6.47      | ●         | -          | -          | -            |  |  |  |
| Tasker RG11AU         |              | NBLC75BVZ17 |            |                       |           | 1.8   | 10.00     | -         | -          | ●          | -            |  |  |  |
| Tasker TSK1077LSZH    |              | NBNC75BFG7  |            |                       |           | 1.6   | 5.00      | ●         | -          | -          | -            |  |  |  |
| Tasker TSK1078LSZH    | NBNC75BLP9X  | NBNC75BLP9  |            |                       |           | 1.6   | 6.47      | ●         | -          | -          | -            |  |  |  |
| Tasker TSK1079LSZH    | NBNC75BTU11X | NBNC75BTU11 |            |                       |           | 1.07  | 7.36      | ●         | -          | -          | -            |  |  |  |
| Tasker TSK1080LSZH    |              | NBLC75BVZ17 |            |                       |           | 1.8   | 10.00     | -         | -          | ●          | -            |  |  |  |
| Tasker T42 PVC        |              | NBNC75BWU13 |            |                       |           | 1.6   | 7.36      | ●         | -          | -          | -            |  |  |  |
| Tasker T42 PUR        |              | NBNC75BWU13 |            |                       |           | 1.6   | 7.36      | ●         | -          | -          | -            |  |  |  |
| <b>■ Tesca</b>        |              |             |            |                       |           |       |           |           |            |            |              |  |  |  |
| Tesca Bachelor        |              | NBNC75BWU13 |            |                       |           | 1.6   | 7.36      | ●         | -          | -          | -            |  |  |  |
| Tesca Bachelor PUR    |              | NBNC75BZV14 |            |                       |           | 1.6   | 8.23      | -         | ●          | -          | -            |  |  |  |
| Tesca Bengal          |              |             | NBTC75BNS4 |                       |           | 1.6   | 4.53      | ●         | -          | -          | ●            |  |  |  |
| Tesca DUBLO V         |              | NBNC75BWU13 |            |                       |           | 1.6   | 7.36      | ●         | -          | -          | -            |  |  |  |
| Tesca Fabio 12G       |              | NBNC75BUU11 |            |                       |           | 1.6   | 7.36      | ●         | -          | -          | -            |  |  |  |
| Tesca KXV6            |              | NBNC75BLP7  |            |                       |           | 1.6   | 6.47      | ●         | -          | -          | -            |  |  |  |
| Tesca Supra           | NBNC75BFG7X  | NBNC75BFG7  |            |                       | 1.07      | 1.6   | 5.00      | ●         | -          | -          | -            |  |  |  |
| Tesca Massimo         |              | NBLC75BSX14 |            |                       |           | 1.75  | 9.73      | -         | ●          | -          | -            |  |  |  |
| Tesca Sphere          |              | NBLC75BVZ17 |            |                       |           | 1.8   | 10.00     | -         | -          | ●          | -            |  |  |  |
| Tesca Presto          |              | NBNC75BJP9  |            |                       |           | 1.6   | 6.47      | ●         | -          | -          | -            |  |  |  |
| Tesca Prima           |              | NBNC75BTS11 |            |                       |           | 1.6   | 7.01      | ●         | -          | -          | -            |  |  |  |
| Tesca Linea           |              | NBNC75BNP9  |            |                       |           | 1.6   | 6.47      | ●         | -          | -          | -            |  |  |  |
| Tesca Vostok          |              | NBNC75BWS12 |            |                       |           | 1.6   | 7.01      | ●         | -          | -          | -            |  |  |  |
| Tesca Dublo           |              | NBNC75BWS12 |            |                       |           | 1.6   | 7.01      | ●         | -          | -          | -            |  |  |  |

|  | rearTWIST | rearTWIST | rearTWIST | Cable Jack<br>& Panel | Pin Crimp |       | Hex Crimp | Stripping |            |            |              |  |  |  |
|--|-----------|-----------|-----------|-----------------------|-----------|-------|-----------|-----------|------------|------------|--------------|--|--|--|
|  | UHD       | HD        | HD Tiny   |                       | in mm     | in mm | in mm     | Tool      |            |            |              |  |  |  |
|  |           |           |           |                       | UHD       | HD    |           | CS-BNC-RT | CS-BNC-LCS | CS-BNC-LCV | + CS-BNC-TCI |  |  |  |

**■ Van Damme**

|                       |              |             |            |  |      |     |       |   |   |   |   |  |  |  |
|-----------------------|--------------|-------------|------------|--|------|-----|-------|---|---|---|---|--|--|--|
| Van Damme 268-175-000 | NBNC75BUU11X | NBNC75BUU11 |            |  | 1.07 | 1.6 | 7.36  | ● | - | - | - |  |  |  |
| Van Damme 268-275-000 | NBNC75BJP9X  | NBNC75BJP9  |            |  | 1.07 | 1.6 | 6.47  | ● | - | - | - |  |  |  |
| Van Damme 268-306-000 | NBNC75BLP9X  | NBNC75BLP9  |            |  | 1.07 | 1.6 | 6.47  | ● | - | - | - |  |  |  |
| Van Damme 268-408-000 |              |             | NBTC75BF4  |  |      | 1.6 | 6.47  | ● | - | - | ● |  |  |  |
| Van Damme 268-475-000 | NBNC75BTU11X | NBNC75BTU11 |            |  | 1.07 | 1.6 | 7.36  | ● | - | - | - |  |  |  |
| Van Damme 268-675-000 | NBNC75BTU11X | NBNC75BTU11 |            |  | 1.07 | 1.6 | 7.36  | ● | - | - | - |  |  |  |
| Van Damme 278-475-000 |              | NBLC75BVZ17 |            |  |      | 1.8 | 10.00 | - | - | ● | - |  |  |  |
| Van Damme 278-175-000 | NBNC75BUU11X | NBNC75BUU11 |            |  | 1.07 | 1.6 | 7.36  | ● | - | - | - |  |  |  |
| Van Damme 278-975-000 | NBNC75BLP9X  | NBNC75BLP9  |            |  | 1.07 | 1.6 | 6.47  | ● | - | - | - |  |  |  |
| Van Damme 278-775-000 |              |             | NBTC75BSS5 |  |      | 1.6 | 4.53  | ● | - | - | ● |  |  |  |
| Van Damme 278-075-000 | NBNC75BFG7X  | NBNC75BFG7  |            |  | 1.07 | 1.6 | 5.00  | ● | - | - | - |  |  |  |
| Van Damme 278-075-006 | NBNC75BFG7X  | NBNC75BFG7  |            |  | 1.07 | 1.6 | 5.00  | ● | - | - | - |  |  |  |
| Van Damme 278-375-000 | NBNC75BUU11X | NBNC75BUU11 |            |  | 1.07 | 1.6 | 7.36  | ● | - | - | - |  |  |  |

**■ Others**

|                            |              |             |            |            |      |      |       |   |   |   |   |  |  |  |
|----------------------------|--------------|-------------|------------|------------|------|------|-------|---|---|---|---|--|--|--|
| AT&T 735                   |              |             | NBTC75BSS5 |            |      | 1.6  | 4.53  | ● | - | - | ● |  |  |  |
| COMM-TEC RGBHV             |              |             | NBTC75BSS5 |            |      | 1.6  | 4.53  | ● | - | - | ● |  |  |  |
| BBC PSF 1/3*               |              | NBNC75BLS7  |            |            |      | 1.6  | 7.01  | ● | - | - | - |  |  |  |
| COVID CVD 1300-1500        |              |             | NBTC75BLI5 | NBTB75CLI5 |      | 1.6  | 4.06  | ● | - | - | ● |  |  |  |
| Eupen 705 CRT 5V-HS        |              | NBNC75BTS11 |            |            |      | 1.6  | 7.36  | ● | - | - | - |  |  |  |
| Extron BNC-5HR             |              |             | NBTC75BNN5 | NBTB75CNN5 |      | 1.6  | 4.53  | ● | - | - | ● |  |  |  |
| Extron BNC-5SRC            | NBNC75BFG7X  | NBNC75BFG7  |            |            | 1.07 | 1.6  | 5.00  | ● | - | - | - |  |  |  |
| GEPCO VDM230               | NBNC75BDD6X  | NBNC75BDD6  |            |            | 1.07 | 1.6  | 4.53  | ● | - | - | - |  |  |  |
| GEPCO VPM2000              | NBNC75BLP9X  | NBNC75BLP9  |            | NBNB75GLP9 | 1.07 | 1.6  | 6.47  | ● | - | - | - |  |  |  |
| GEPCO VSD2001              | NBNC75BTU11X | NBNC75BTU11 |            |            | 1.07 | 1.6  | 7.36  | ● | - | - | - |  |  |  |
| Helix 734                  |              | NBNC75BNP9  |            |            |      | 1.6  | 6.47  | ● | - | - | - |  |  |  |
| Helix 735                  |              |             | NBTC75BSS5 |            |      | 1.6  | 4.53  | ● | - | - | ● |  |  |  |
| Hirschmann KOKA 712Cu      |              | NBNC75BTS9  |            |            |      | 1.6  | 6.47  | ● | - | - | - |  |  |  |
| Kansai 3C-5S               |              | NBNC75BFH6  |            |            |      | 1.6  | 5.00  | ● | - | - | - |  |  |  |
| Kelsey SD-1                | NBNC75BFG7X  | NBNC75BFG7  |            |            | 1.07 | 1.6  | 5.00  | ● | - | - | - |  |  |  |
| Kelsey SD-1-LL             |              | NBNC75BWS11 |            |            |      | 1.6  | 7.01  | ● | - | - | - |  |  |  |
| KROSCHU (341 270, 341 280) |              |             | NBTC75BLI4 |            | 1.6  | 4.06 | ●     | - | - | ● | - |  |  |  |
| Pro Plex RG6 TMB           | NBNC75BUU11X | NBNC75BUU11 |            |            | 1.07 | 1.6  | 7.36  | ● | - | - | - |  |  |  |
| Pro Plex RG11              |              | NBLC75BVZ17 |            |            |      | 1.8  | 10.00 | - | - | ● | - |  |  |  |
| Pro Plex RG59              | NBNC75BUU11X | NBNC75BUU11 |            |            | 1.07 | 1.6  | 7.36  | ● | - | - | - |  |  |  |
| Quadronics CABPGHD70MW-500 |              | NBNC75BFG7  |            |            | 1.07 | 1.6  | 5.00  | ● | - | - | - |  |  |  |
| Wisi MK 99A                |              | NBNC75BWS12 |            |            |      | 1.6  | 6.47  | ● | - | - | - |  |  |  |
| ZNK CM14B                  |              |             | NBTC75BF4  | NBTB75CF4  |      | 1.6  | 4.06  | ● | - | - | ● |  |  |  |

\* Registered trademark of BBC

|  | Inner Conductor | Insulator | Cable O.D. mm | Pin crimp mm (square) | Hex Crimp mm | Stripping Tool |            |            |              |
|--|-----------------|-----------|---------------|-----------------------|--------------|----------------|------------|------------|--------------|
|  |                 |           |               |                       |              | CS-BNC-RT      | CS-BNC-LCS | CS-BNC-LCV | + CS-BNC-TCI |

## rearTWIST HD & UHD

|               |       |       |        |                   |       |   |   |   |   |
|---------------|-------|-------|--------|-------------------|-------|---|---|---|---|
| NBLC75BVZ17   | < 1.7 | < 8.0 | < 10.4 | 1.80 (Hex crimp)  | 10.00 | - | - | ● | - |
| NBLC75BSX14   | < 1.4 | < 6.6 | < 9.5  | 1.75 (Hex crimp)  | 9.73  | - | ● | - | - |
| NBNC75BDD6    | < 0.6 | < 2.8 | < 4.3  | 1.6               | 4.53  | ● | - | - | - |
| NBNC75BDD6X   | < 0.6 | < 2.8 | < 4.3  | 1.07              | 4.53  | ● | - | - | - |
| NBNC75BFG7    | < 0.7 | < 3.1 | < 4.7  | 1.6               | 5.00  | ● | - | - | - |
| NBNC75BFG7X   | < 0.7 | < 3.1 | < 4.7  | 1.07              | 5.00  | ● | - | - | - |
| NBNC75BFH6    | < 0.6 | < 3.1 | < 4.9  | 1.6               | 5.00  | ● | - | - | - |
| NBNC75BGG7    | < 0.7 | < 3.2 | < 4.7  | 1.6               | 5.00  | ● | - | - | - |
| NBNC75BHK7    | < 0.7 | < 3.3 | < 5.6  | 1.6 (or 1.75 Hex) | 5.41  | ● | - | - | - |
| NBNC75BIJ9    | < 0.9 | < 3.6 | < 5.3  | 1.6               | 5.41  | ● | - | - | - |
| NBNC75BIJ9    | < 0.9 | < 3.8 | < 5.3  | 1.6               | 5.41  | ● | - | - | - |
| NBNC75BJP9    | < 0.9 | < 3.8 | < 6.3  | 1.6               | 6.47  | ● | - | - | - |
| NBNC75BJP9X   | < 0.9 | < 3.8 | < 6.3  | 1.07              | 6.47  | ● | - | - | - |
| NBNC75BLP7    | < 0.7 | < 3.8 | < 6.3  | 1.6               | 6.47  | ● | - | - | - |
| NBNC75BLP7X   | < 0.7 | < 3.8 | < 6.3  | 1.07              | 6.47  | ● | - | - | - |
| NBNC75BLP9    | < 0.9 | < 3.8 | < 6.3  | 1.6               | 6.47  | ● | - | - | - |
| NBNC75BLP9X   | < 0.9 | < 3.8 | < 6.3  | 1.07              | 6.47  | ● | - | - | - |
| NBNC75BLS7    | < 0.7 | < 3.8 | < 6.9  | 1.6               | 7.01  | ● | - | - | - |
| NBNC75BNP9    | < 0.9 | < 4.1 | < 6.3  | 1.6               | 6.47  | ● | - | - | - |
| NBNC75BQP11   | < 1.1 | < 4.5 | < 6.3  | 1.6               | 6.47  | ● | - | - | - |
| NBNC75BQP11X  | < 1.1 | < 4.5 | < 6.3  | 1.07              | 6.47  | ● | - | - | - |
| NBNC75BRS9    | < 0.9 | < 4.8 | < 6.9  | 1.6               | 7.01  | ● | - | - | - |
| NBNC75BTS9    | < 0.9 | < 4.7 | < 6.9  | 1.6               | 7.01  | ● | - | - | - |
| NBNC75BTS11   | < 1.1 | < 4.7 | < 6.9  | 1.6               | 7.01  | ● | - | - | - |
| NBNC75BTU11   | < 1.1 | < 4.7 | < 7.3  | 1.6               | 7.36  | ● | - | - | - |
| NBNC75BTU11X  | < 1.1 | < 4.7 | < 7.3  | 1.07              | 7.36  | ● | - | - | - |
| NBNC75BTUP11X | < 1.1 | < 4.7 | < 7.3  | 1.07              | 7.06  | ● | - | - | - |
| NBNC75BTU13   | < 1.4 | < 4.7 | < 7.3  | 1.6               | 7.36  | ● | - | - | - |
| NBNC75BUU11   | < 1.1 | < 4.9 | < 7.3  | 1.6               | 7.36  | ● | - | - | - |
| NBNC75BUU11X  | < 1.1 | < 4.9 | < 7.3  | 1.07              | 7.36  | ● | - | - | - |
| NBNC75BRU11   | < 1.1 | < 4.8 | < 7.3  | 1.6               | 7.36  | ● | - | - | - |
| NBNC75BWS11   | < 1.1 | < 5.1 | < 6.9  | 1.6               | 7.01  | ● | - | - | - |
| NBNC75BWS12   | < 1.2 | < 5.1 | < 6.9  | 1.6               | 7.01  | ● | - | - | - |
| NBNC75BWU13   | < 1.4 | < 5.1 | < 7.3  | 1.6               | 7.36  | ● | - | - | - |
| NBNC75BXU13   | < 1.4 | < 5.3 | < 7.3  | 1.6               | 7.36  | ● | - | - | - |
| NBNC75BXY9    | < 0.9 | < 5.3 | < 8.0  | 1.6               | 8.23  | ● | - | - | - |
| NBNC75BYY9    | < 0.9 | < 5.2 | < 8.0  | 1.6               | 8.23  | ● | - | - | - |
| NBNC75BYY11   | < 1.1 | < 5.2 | < 8.0  | 1.6               | 8.23  | ● | - | - | - |
| NBNC75BZV14   | < 1.4 | < 5.2 | < 8.2  | 1.6 (or 1.75 Hex) | 8.23  | ● | - | - | - |
| NBNC75BZV14X  | < 1.4 | < 5.2 | < 8.2  | 1.6 (or 1.75 Hex) | 8.23  | ● | - | - | - |
| NBNC75BXU13X  | < 1.4 | < 5.3 | < 7.3  | 1.6               | 7.36  | ● | - | - | - |

|  | Inner Conductor | Insulator | Cable O.D. mm | Pin crimp mm (square) | Hex Crimp mm | Stripping Tool |            |            |              |
|--|-----------------|-----------|---------------|-----------------------|--------------|----------------|------------|------------|--------------|
|  |                 |           |               |                       |              | CS-BNC-RT      | CS-BNC-LCS | CS-BNC-LCV | + CS-BNC-TCI |

## rearTWIST TINY

|            |       |       |       |     |      |   |   |   |   |
|------------|-------|-------|-------|-----|------|---|---|---|---|
| NBTC75BFI4 | < 0.4 | < 1.6 | < 2.9 | 1.6 | 4.06 | • | - | - | • |
| NBTC75BLI4 | < 0.4 | < 1.8 | < 2.9 | 1.6 | 4.06 | • | - | - | • |
| NBTC75BLI5 | < 0.5 | < 1.8 | < 2.9 | 1.6 | 4.06 | • | - | - | • |
| NBTC75BNN5 | < 0.5 | < 2.0 | < 3.1 | 1.6 | 4.53 | • | - | - | • |
| NBTC75BNS4 | < 0.4 | < 2.0 | < 3.5 | 1.6 | 4.53 | • | - | - | • |
| NBTC75BSS5 | < 0.5 | < 2.3 | < 3.4 | 1.6 | 4.53 | • | - | - | • |
| NBTC75BVV5 | < 0.5 | < 2.5 | < 3.8 | 1.6 | 5.00 | • | - | - | • |
| NBTC75BVX6 | < 0.6 | < 2.5 | < 4.0 | 1.6 | 5.00 | • | - | - | • |
| NBTC75BXX5 | < 0.5 | < 2.6 | < 4.0 | 1.6 | 5.00 | • | - | - | • |
| NBTC75BXX6 | < 0.6 | < 2.6 | < 4.0 | 1.6 | 5.00 | • | - | - | • |

## CABLE JACKS (TINY & PANEL VERSION)

|             |       |       |       |     |      |   |   |   |   |
|-------------|-------|-------|-------|-----|------|---|---|---|---|
| NBTB75CFI4  | < 0.4 | < 1.6 | < 2.9 | 1.6 | 4.06 | • | - | - | • |
| NBTB75CNN5  | < 0.5 | < 2.0 | < 3.1 | 1.6 | 4.53 | • | - | - | • |
| NBTB75CLI5  | < 0.5 | < 1.8 | < 2.9 | 1.6 | 4.06 | • | - | - | • |
| NBNB75GLP9  | < 0.9 | < 3.8 | < 6.3 | 1.6 | 6.47 | • | - | - | • |
| NBNB75GUU11 | < 1.1 | < 4.9 | < 7.3 | 1.6 | 7.36 | • | - | - | • |
| NBNB75ILP9  | < 0.9 | < 3.8 | < 6.3 | 1.6 | 6.47 | • | - | - | • |
| NBNB75IUU11 | < 1.1 | < 4.9 | < 7.3 | 1.6 | 7.36 | • | - | - | • |



D-shape metal housing



Gold plated center pin



## UHD BNC Chassis



NBB75DFGX

- Optimized gold plated cage type center contact for UHD signals as 4K or 8K
- Swiss antraloy plating
- Grounded panel mount
- Standard D-shape housing provides flush mounting and protection from damage
- Color coding possible
- Fully compatible with conventional BNC cable connectors

NBB75DFGX

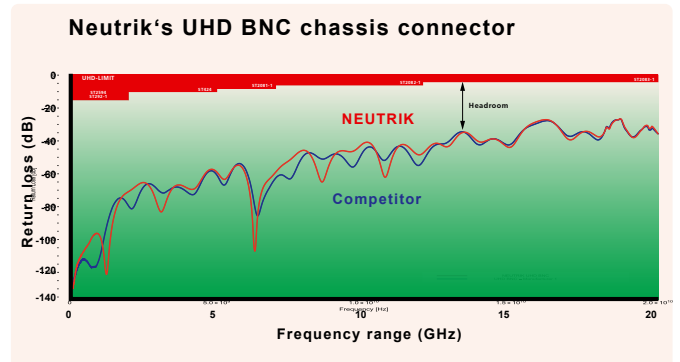
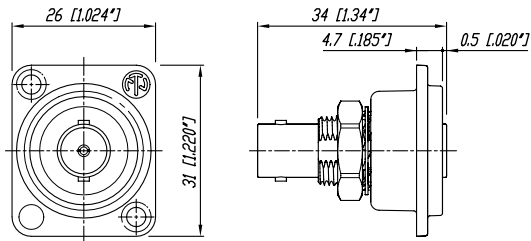

## Ordering Information

|                  |  |
|------------------|--|
| Antraloy housing |  |
| NBB75DFGX        | UHD Bulkhead jack, D-shape housing, feed through, grounded |
| NBB75DFIX        | UHD Bulkhead jack, D-shape housing, feed through, isolated |



D-shape metal housing



Gold plated center pin



## HD BNC Chassis



NBB75DFG



NBB75DFGB

- True 75  $\Omega$  design meets the stringent HDTV / DVD requirements
- Isolated or grounded versions
- "D" shaped housing (provides flush mounting and protection of the jacks from damage) or single feed through mountings
- Gold plated cage type center contact
- Color coding possible

### NBB75DFG

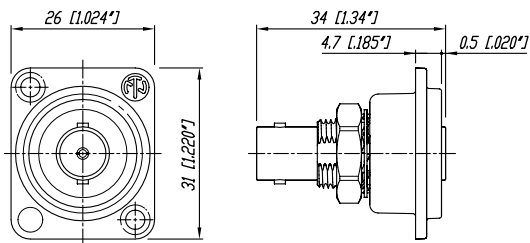

## Ordering Information

| Nickel housing | Black housing | Antraloy housing   |
|----------------|---------------|--|
| NBB75DFG       | NBB75DFGB     | Bulkhead jack, D-shape housing, feed through, grounded   |
| NBB75DFI       | NBB75DFIB     | Bulkhead jack, D-shape housing, feed through, isolated   |
| NBB75DSG       | NBB75DSGB     | Bulkhead jack, D-shape housing, solder version, grounded |
| NBB75DSI       | NBB75DSIB     | Bulkhead jack, D-shape housing, solder version, isolated |



Grounded BNC bulkhead



Isolated BNC bulkhead



## HD BNC Cable Jacks Panel Version



Bulkhead Jacks - NBB75FG & NBB75FI

Cable jacks Panel Version – NBB75SI

- True 75  $\Omega$  design meets the stringent HDTV / DVD requirements
- Isolated panel mount (solves potential grounding problems and prevents common-mode influence with other connections conducted over the same panel ground potential)
- Gold plated cage type center contact
- Extra wide fastening nut avoids damaging the plastic thread

### NBB75FI

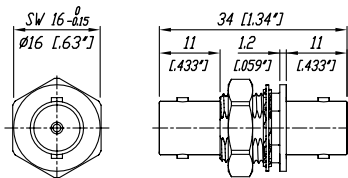

## Ordering Information

Nickel housing

|         |  |
|---------|--|
| NBB75FG | Bulkhead jack, feed through, grounded                      |
| NBB75FI | Bulkhead jack, feed through, isolated                      |
| NBB75SI | Bulkhead jack, solder version, including isolation washers |
| NBB75FA | Coupler, feed through                                      |



| Specifications | rearTWIST<br>UHD | rearTWIST HD &<br>rearTWIST HD Large<br>& Cable Jack<br>Panel | rearTWIST HD<br>Tiny & Cable<br>Jack Tiny | Bulkheads<br>&<br>Coupler |
|----------------|------------------|---|---|---------------------------|
|----------------|------------------|---|---|---------------------------|

| Electrical |  |  |  |  |
|------------|--|--|--|--|
|------------|--|--|--|--|

|                                 |                               |                               |   |                              |                              |
|---------------------------------|-------------------------------|-------------------------------|---|------------------------------|------------------------------|
| Impedance                       | 75 Ω                          | ●                             | ● | ●                            | ●                            |
| Rated voltage                   | 500 V ac rms                  | ●                             | ● | 250 V ac rms                 | ●                            |
| Insulation resistance           | > 5 GΩ                        | ●                             | ● | ●                            | ●                            |
| Dielectric withstanding voltage | 1'500 V ac rms                | ●                             | ● | 750 V ac rms                 | ●                            |
| VSWR / Return Loss              | ≤ 1.050 / > 32 dB up to 1 GHz | ≤ 1.06 / > 30 dB up to 6 GHz  | ● | ≤ 1.10 / > 26 dB up to 1 GHz | ≤ 1.03 / > 37 dB up to 1 GHz |
|                                 | ≤ 1.065 / > 30 dB up to 2 GHz | ≤ 1.13 / > 24 dB up to 12 GHz | ● | ≤ 1.14 / > 24 dB up to 2 GHz | ≤ 1.05 / > 32 dB up to 2 GHz |
|                                 | ≤ 1.100 / > 26 dB up to 3 GHz | ≤ 1.22 / > 20 dB up to 18 GHz | ● | ≤ 1.22 / > 20 dB up to 3 GHz | ≤ 1.08 / > 28 dB up to 3 GHz |
| Inner contact resistance        | ≤ 3 mΩ (initial)              | ●                             | ● | ●                            | ●                            |
| Outer contact resistance        | ≤ 2 mΩ (initial)              | ●                             | ● | ●                            | ●                            |

| Mechanical |  |  |  |  |
|------------|--|--|--|--|
|------------|--|--|--|--|

|                          |                     |           |           |           |       |
|--------------------------|---------------------|-----------|-----------|-----------|-------|
| Cable anchoring          | Jacket crimping     | ●         | ●         | ●         | N / A |
| Cable O.D. range         | mm                  | 4.3 - 7.3 | 4.0 - 7.7 | 2.5 - 3.8 | N / A |
|                          | - Rear Twist Large  | mm        | -         | 10.3      | -     |
| Center contact retention | > 30 N              | ●         | ●         | ●         | -     |
| Engagement force         | < 25 N              | ●         | ●         | ●         | ●     |
| Lifetime                 | 1'000 mating cycles | ●         | ●         | ●         | ●     |

| Material |  |  |  |  |
|----------|--|--|--|--|
|----------|--|--|--|--|

|                  |  |       |       |       |         |
|------------------|--|-------|-------|-------|---------|
| Shell            | Brass (CuZn39Pb3)                                    | ●     | ●     | ●     | ●       |
|                  | Optalloy coated                                      | -     | ●     | ●     | ●       |
|                  | Anraloy coated                                       | ●     | -     | -     | -       |
|                  | PA6 (Push Pull only)                                 | -     | N / A | N / A | N / A   |
| D-Shape housing: | Zinc diecast (ZnAl4Cu1)<br>gal Ni or black Cr platin | N / A | N / A | N / A | NBB75D* |
|                  | Anraloy coated                                       | ●     | -     | -     | -       |
| Ground contact   | Bronze (CuSn6)                                       | ●     | ●     | ●     | -       |
|                  | 0.2 μm AuCo over 2 μm NiP15                          | ●     | ●     | ●     | -       |
|                  | Brass (CuZn39Pb3)                                    | -     | -     | -     | ●       |
|                  | OPTALLOY coated                                      | -     | -     | -     | ●       |
| Center contact   | Brass (CuZn35Pb2)                                    | ●     | ●     | ●     | -       |
|                  | 0.2 μm AuCo or                                       | ●     | ●     | ●     | -       |
|                  | Brass (CuZn39Pb3)                                    | -     | -     | -     | ●       |
| Insulator        | 0.2 μm AuCo  | -     | -     | -     | ●       |
|                  | Teflon PTFE  | -     | ●     | ●     | ●       |
| Chuck            | Polypropylen PP                                      | ●     | -     | -     | -       |
|                  | Polyacetal POM                                       | N / A | N / A | N / A | N / A   |
| Insulation Shell | Polyacetal POM                                       | N / A | N / A | N / A | ●       |

| Environmental |  |  |  |  |
|---------------|--|--|--|--|
|---------------|--|--|--|--|

|                               |                           |   |   |   |       |
|-------------------------------|---------------------------|---|---|---|-------|
| Temperature range             | -30 °C to +85 °C          | ● | ● | ● | ●     |
| Solderability complies with   | IEC 68-2-20               | ● | ● | ● | N / A |
| Contact crimpability complies | IEC 60803 and IEC 60352-2 | ● | ● | ● | N / A |

## Colour Coded Accessories and Seals



|           |  |
|-----------|--|
| BST-BNC-* | Standard boot for the rearTWIST BNCs in black, 9 different colors available                        |
| DSS-*     | Lettering plate for D Shape bulkheads.   |
| SCF       | Rubber sealing cover to protect the connector against dust and moisture                            |
| SCDP-*    | D-Size sealing gaskets, color coding (*: 0- black, 2- red, 4- yellow, 5- green, 6- blue, 9- white) |
| SCDX      | Hinged cover seals D-size chassis connectors, IP 42 rated  |
| SCCD-W    | Spring-loaded cover to seals for D-size chassis connectors, IP 65 rated                            |

\*: 0 - Black, 1 - Brown, 2 - Red, 3 - Orange, 4 - Yellow, 5 - Green, 6 - Blue, 7 - Violet, 8 - Grey, 9 - White



## Assembly Tools



CAS-BNC-T



CS-BNC-RT



HX-R-BNC



PT-BNC



DIE-R-BNC-\*

|            |   |             |   |
|------------|---|-------------|---|
| CAS-BNC-T  | BNC tool case equipped with HX-R-BNC, PT-BNC: Plier tool, CS-BNC-RT: Stripping tool | CS-BNC-LCV  | Coax cable stripper for cable O.D. > 8 mm (NBLC75BVZ17) |
| CS-BNC-RT  | Coax cable stripper for cable O.D. 2.5 – 8 mm                                       | DIE-R-BNC-* | Crimp tool die for pin and shield for HX-R-BNC          |
| CS-BNC-LCS | Coax cable stripper for cable O.D. > 8 mm (NBLC75BSX14)                             | HX-R-BNC    | Crimp tool, frame                                       |
|            |   | PT-BNC      | BNC pliers tool   |

## Crimp die assignment for HX-R-BNC

| Crimp die | Hex crimp mm |   |   | Hex crimp inch |   |   | Center pin mm (square crimp) |
|-----------|--------------|---|---|----------------|---|---|------------------------------|
|           | A            | B | C | A              | B | C |                              |

### rearTWIST HD BNC

|               |      |      |      |       |       |       |     |
|---------------|------|------|------|-------|-------|-------|-----|
| DIE-R-BNC-PDC | 6.47 | 4.53 | 4.06 | 0.255 | 0.178 | 0.160 | 1.6 |
| DIE-R-BNC-PG  | 6.47 | 5.00 | -    | 0.255 | 0.197 | -     | 1.6 |
| DIE-R-BNC-PJ  | 6.47 | 5.41 | -    | 0.255 | 0.213 | -     | 1.6 |
| DIE-R-BNC-PS  | 6.47 | 7.01 | -    | 0.255 | 0.276 | -     | 1.6 |
| DIE-R-BNC-PU  | 6.47 | 7.36 | -    | 0.255 | 0.290 | -     | 1.6 |
| DIE-R-BNC-PY  | 6.47 | 8.23 | -    | 0.255 | 0.324 | -     | 1.6 |

| Crimp die | Hex crimp mm |   |   | Hex crimp inch |   |   | Center pin mm (square crimp) |
|-----------|--------------|---|---|----------------|---|---|------------------------------|
|           | A            | B | C | A              | B | C |                              |

|                          |      |      |      |       |       |       |                  |
|--------------------------|------|------|------|-------|-------|-------|------------------|
| DIE-R-BNC-X              | 9.73 | -    | -    | 0.383 | -     | -     | 1.75 (Hex Crimp) |
| DIE-R-BNC-UG             | 7.36 | 5.00 | -    | 0.290 | 0.197 | -     | 1.6              |
| DIE-R-BNC-ZPLUS          | 10.0 | -    | -    | 0.39  | -     | -     | 1.8              |
| <b>rearTWIST UHD BNC</b> |      |      |      |       |       |       |                  |
| DIE-R-BNCX-PDG           | 6.47 | 5.00 | 4.53 | 0.255 | 0.197 | 0.178 | 1.07             |
| DIE-R-BNCX-PU            | 6.47 | 7.36 | -    | 0.255 | 0.290 | -     | 1.07             |
| DIE-R-BNCX-PY            | 6.47 | 8.23 | -    | 0.255 | 0.324 | -     | 1.07             |

## Definitions, Abbreviations & Useful Information

### ELEMENTS

|           |                 |
|-----------|-----------------|
| <b>Ag</b> | Silver          |
| <b>Al</b> | Aluminium       |
| <b>Au</b> | Gold            |
| <b>Co</b> | Cobalt          |
| <b>Cr</b> | Chromium        |
| <b>Cu</b> | Copper          |
| <b>Ni</b> | Nickel          |
| <b>P</b>  | Phosphorus      |
| <b>Pb</b> | Lead            |
| <b>Pd</b> | Palladium       |
| <b>Sn</b> | Tin             |
| <b>Zn</b> | Zinc            |
| <b>SS</b> | Stainless Steel |

### ALLOYS, PLASTICS, POLYMERS

|                       |                                  |
|-----------------------|----------------------------------|
| <b>Brass (Alloy)</b>  | CuZn39Pb3                        |
| <b>Bronze (Alloy)</b> | CuSn6                            |
| <b>Ck 67</b>          | Carbon Steel                     |
| <b>EPDM</b>           | Ethylene Propylene               |
| <b>GR</b>             | Glass Reinforced                 |
| <b>PA</b>             | Polyamide                        |
| <b>PBTP</b>           | Polybutylene Terephthalate       |
| <b>POM</b>            | Polyacetal                       |
| <b>PTFE</b>           | PolyTetraFluoroEthylene (TEFLON) |
| <b>PUR</b>            | Polyurethane                     |

### MEASUREMENT LEGEND

|           |                  |
|-----------|------------------|
| <b>N</b>  | Newton           |
| <b>Ω</b>  | Ohm              |
| <b>μ</b>  | Micro            |
| <b>OD</b> | Outside Diameter |
| <b>m</b>  | Meter(s)         |
| <b>k</b>  | Kilo             |

### ENGLISH TO METRIC CONVERSIONS



|                  |         |                  |
|------------------|---------|------------------|
| <b>1/8 inch</b>  | 3.175   | millimeters (mm) |
| <b>1/4 inch</b>  | 6.35    | millimeters (mm) |
| <b>1 inch</b>    | 25.4    | millimeters (mm) |
|                  | 2.54 cm | 1 inch           |
| <b>1 foot</b>    | 30.48   | centimeters (cm) |
|                  | 0.305   | meter (m)        |
| <b>6 foot</b>    | 1.828   | meters (m)       |
| <b>50 foot</b>   | 15.24   | meters (m)       |
| <b>100 foot</b>  | 30.48   | meters (m)       |
| <b>1000 foot</b> | 304.8   | meters (m)       |

### METRIC TO ENGLISH CONVERSIONS

|                     |         |        |
|---------------------|---------|--------|
| <b>1 centimeter</b> | 0.3937  | inches |
| <b>1 meter</b>      | 39.37   | inches |
| <b>3.281 meter</b>  | 10      | feet   |
| <b>10 meters</b>    | 32.808  | feet   |
| <b>50 meters</b>    | 164.041 | feet   |
| <b>100 meters</b>   | 328.084 | feet   |

### OTHER ABBREVIATIONS

|   |   |
|---|---|
| <b>UL®</b>  | Underwriters Laboratories   |
| <b>IP Rating</b>  | Ingress Protection rating for objects and water ACC IEC529/EN60529  |
| <b>IEC</b>  | International Electrotechnical Commission is the international standards and conformity assessment body for all fields of electrotechnology |
|  | UL Recognized Component Mark  |

|   |  |
|---|--|
|  | <b>ENEC</b> – European norms electrical certification, demonstrates compliance with European safety standards. |
|  | <b>VDE</b> Association for Electrical, Electronic and Information Technologies e.V.                            |
| <b>AWG</b>  | American Wire Gauge  |

**NEUTRIK, crystalCON®, etherCON®, maxCON®, miniCON®, nanoCON®, neutriCON®, opticalCON®, powerCON®, powerCON® TRUE1®, Profi®, rearTWIST®, silentPLUG®, speakON®, TOP®, DiWA®, XIRIUM®, are registered trademarks of Neutrik AG.**

## Neutrik® Part Number Guide

### NC3FAH1-B-0-D

|                            |  |  |
|----------------------------|--|--|
| <b>Packaging:</b>          | <b>D</b>   | Cable connector: bulk packed                                       |
| <b>Assembly:</b>           | <b>D</b>   | Chassis connector: disassembled push latch                         |
| <b>Retention:</b>          | <b>w/o</b>   | Latch lock   |
|                            | <b>-0</b>  | Retention spring   |
|                            | <b>-DA</b>   | Asymmetric PUSH  |
|                            | <b>B</b>   | Black shell, gold contacts   |
| <b>Shell:</b>              | <b>BAG</b>   | Black shell, silver contacts                                       |
|                            | <b>0</b>   | Separate ground contact connected to shell, male only              |
| <b>Grounding:</b>          | <b>1</b>   | Pin 1 & panel & shell connected, no separate ground contact        |
|                            | <b>2</b>   | Separate ground contact connected to shell & panel, separate Pin 1 |
|                            | <b>E</b>   | Additional ground contacts   |
|                            | <b>w/o number</b>                                  | No ground/shell contact (except 4/5 pole), female only             |
|                            | <b>Termination:</b>                                | <b>H</b>   |
|                            | <b>HL</b>  | Lateral left PCB mount   |
|                            | <b>HR</b>  | Lateral right PCB mount  |
|                            | <b>L</b>   | Solder cups  |
|                            | <b>V</b>   | Vertical PCB mount   |
|                            | <b>Y</b>   | IDC for wires (no ground)  |
|                            | <b>M3</b>  | Mounting holes with M3 thread                                      |
|                            | <b>M25</b>   | Mounting holes with M2.5 thread                                    |
|                            | <b>-</b>   | Not applicable   |
| <b>Series:</b>             | <b>A, AA, B, D, DL, DLX, MPR, P, PX, RX, X, XX</b> |  |
| <b>Gender:</b>             | <b>F</b>   | Female   |
|                            | <b>M</b>   | Male   |
| <b>Number of Contacts:</b> | <b>2, 3, 4, 5, 6, 7, 8, 12</b>                     |  |
| <b>Connector Type:</b>     | <b>A</b>   | Adapter  |
|                            | <b>AC</b>  | powerCON®  |
|                            | <b>B</b>   | BNC  |
|                            | <b>C</b>   | XLR  |
|                            | <b>D</b>   | dummyPLUG  |
|                            | <b>E</b>   | etherCON® - RJ45   |
|                            | <b>F</b>   | RCA / CINCH  |
|                            | <b>J (MJ, RJ, SJ)</b>                              | Jack   |
|                            | <b>K</b>   | Cable Assembly   |
|                            | <b>L</b>   | speakON® - Loudspeaker   |
|                            | <b>M</b>   | Module   |
|                            | <b>O</b>   | opticalCON® - Fiber Optic Connector                                |
|                            | <b>P</b>   | Plug   |
|                            | <b>PP</b>  | Patch Panel  |
|                            | <b>R</b>   | Circular Connector   |
|                            | <b>T</b>   | Transformer  |
|                            | <b>TOP</b>   | True Outdoor Protection  |

Definitions, abbreviations & useful information see page 19.

# Neutrik® Product Line

|  |   |  |  |   |  |   |   |
|--|---|--|--|---|--|---|---|
| <p><b>XLR Connectors</b></p> <p>X Series<br/>XX Series<br/>TOP Series<br/>RX Series<br/>X5 Series<br/>A Series<br/>AA Series<br/>B Series<br/>TOP Series<br/>D Series<br/>DLX Series<br/>P Series<br/>MPR Series<br/>Combo I Series<br/>Combo A Series</p> | <p><b>Plugs &amp; Jacks</b></p> <p>PX Series<br/>silentPLUG®<br/>timbrePLUG®<br/>ultimatePLUG®<br/>MIL/B-Gauge Type Plugs<br/>0.173" Bantam<br/>3.5 mm Plug</p> | <p><b>speaKON® Connectors</b></p> <p>speaKON® SPX Series<br/>speaKON® FXX Series<br/>speaKON® FC Series<br/>speaKON® Adapter<br/>speaKON® Chassis Connector<br/>speaKON® Combo</p> | <p><b>Data Connectors</b></p> <p>HDMI Cable &amp; Chassis Connectors<br/>etherCON® Cable &amp; Chassis Connectors<br/>etherCON® TOP<br/>mediaCON Cable &amp; Chassis Connectors<br/>USB Cable &amp; Chassis Connectors</p> | <p><b>Circular Connectors</b></p> <p>rearTWIST®<br/>nanoCON® Cable &amp; Chassis Connectors<br/>miniCON® Cable &amp; Chassis Connectors<br/>neutriCON® Cable &amp; Chassis Connectors</p> | <p><b>powerCON® Connectors</b></p> <p>powerCON® Cable &amp; Chassis Connectors<br/>powerCON® TRUE1® TOP Cable &amp; Chassis Connectors<br/>32 A powerCON® Cable &amp; Chassis Connectors</p> | <p><b>Patch Panels</b></p> <p>1/4" Patch Panel<br/>NPPA Series - 96 Bantam (TT) Jacks<br/>LF 48 B-Gauge Patchbays</p> | <p><b>Digital Audio Network</b></p> <p>NA2-IO-DPRO<br/>NA2-IO-DLINE<br/>NFS-30W</p> |
|--|---|--|--|---|--|---|---|

# NEUTRIK®

The premium brand of the Neutrik Group

## LIECHTENSTEIN (HEADQUARTERS)

Neutrik AG, Im alten Riet 143, 9494 Schaan  
T +423 237 24 24, F +423 232 53 93, neutrik@neutrikgroup.com

## GERMANY / NETHERLANDS / DENMARK / AUSTRIA

Neutrik EMEA GmbH, Felix-Wankel-Straße 1, 85221 Dachau, Germany  
T +49 8131 28 08 90, neutrik@neutrikgroup.de

## GREAT BRITAIN

Neutrik (UK) Ltd., Westridge Business Park, Cothey Way  
Ryde, Isle of Wight PO33 1 QT  
T +44 1983 811 441, sales@neutrikgroup.co.uk

## FRANCE

Neutrik France SARL, 52 rue d'aguesseau, 1er etage, 92100 Boulogne-Billancourt  
T +33 1 41 31 67 50, info@neutrikgroup.fr

## USA

NeutrikAmericas, 4115 Taggart Creek Road, Charlotte, North Carolina, 28208  
T +1 704 972 3050, info@neutrikusa.com

## JAPAN

Neutrik Limited, Yusen-Higashinohonbashi-Ekimae Bldg., 3-7-19  
Higashinohonbashi, Chuo-ku, Tokyo 103  
T +81 3 3663 47 33, mail@neutrik.co.jp

## HONG KONG

Neutrik Hong Kong Ltd., Suite 18, 7th Floor Shatin Galleria  
Fotan, Shatin  
T +852 2687 6055, sales@neutrik.com.hk

## CHINA

Ningbo Neutrik Trading Co., Ltd., Shiqi Street, Yinxian Road West  
Fengjia Village, Hai Shu Area, Ningbo, Zhejiang, 315153  
T +86 574 88250833, sales@neutrik.com.cn

## ASSOCIATED COMPANIES

### Contrik AG

Steinackerstrasse 35, 8902 Urdorf, Switzerland  
T +41 44 736 50 10, contrik@contrik.ch

### H. Adam GmbH

Felix-Wankel-Straße 1, 85221 Dachau, Germany  
T +49 08131 28 08-0, anfrage@adam-gmbh.de

### CONNEX GmbH

Elberstraße 12, 26135 Oldenburg, Germany  
T +49 441 380398-0, info@connex.de



[www.neutrik.com](http://www.neutrik.com)